

PROJECT LOCATION

CONSULTANT:

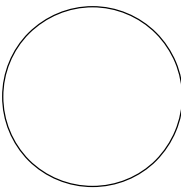

IOWA DEPARTMENT OF NATURAL RESOURCES

ENGINEERING SERVICES - WALLACE BUILDING
502 E. 9TH ST., DES MOINES, IA 50319-0034



PROJECT LOCATION MAP

PAVEMENT PRESERVATION FOR:

UNION GROVE STATE PARK

TAMA COUNTY

NO.	BY	REVISION

DRAWN BY: PROJECT NUMBER:
TDD 22-05-86-01

CHK'D BY: DATE:
NOVEMBER 2022

SHEET NO:

A.02

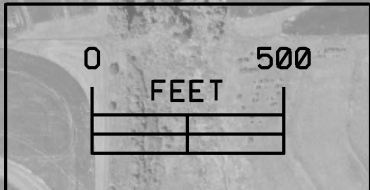
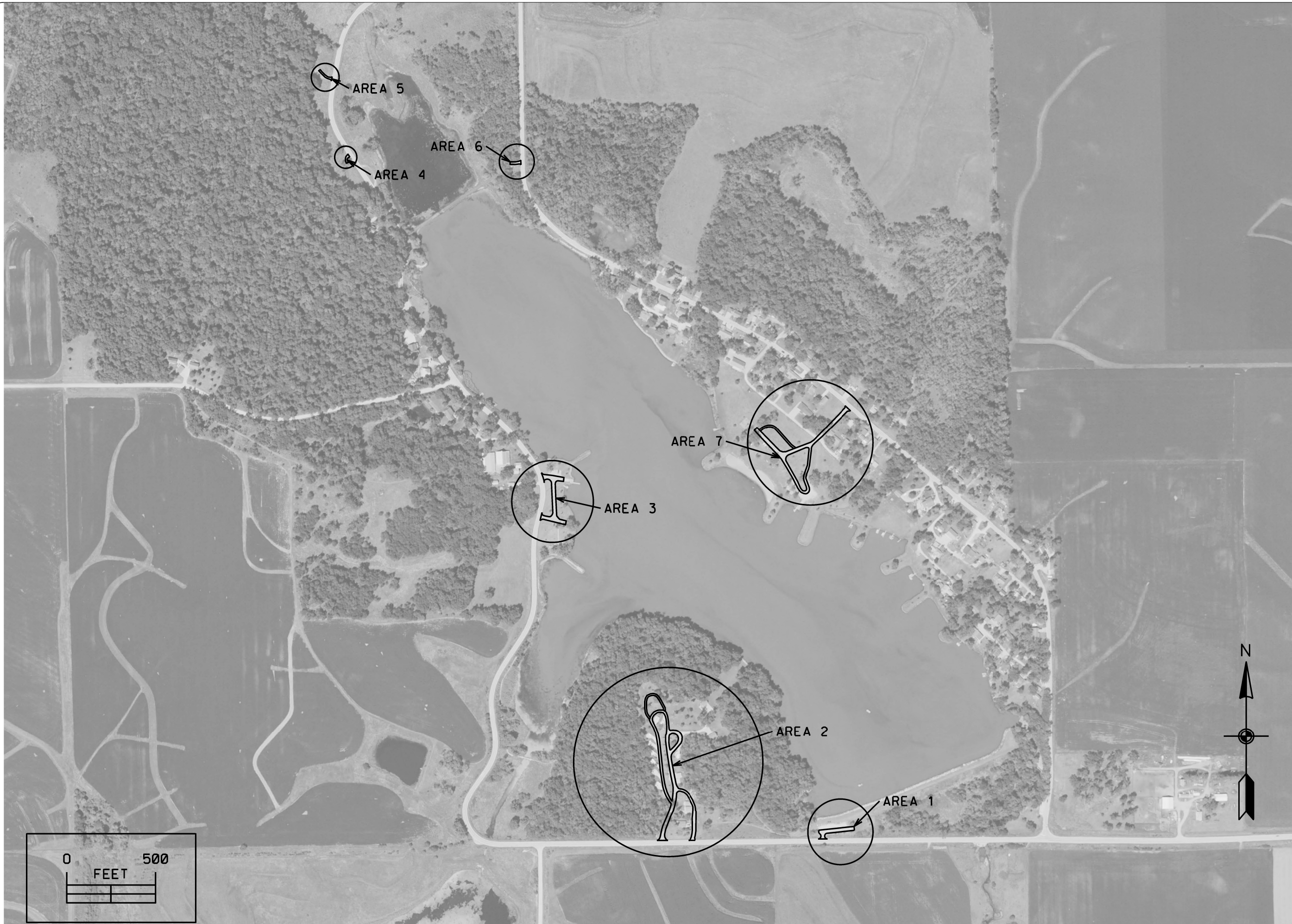

CONSULTANT:

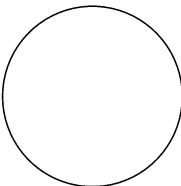

**IOWA DEPARTMENT OF
NATURAL RESOURCES**

ENGINEERING SERVICES - WALLACE BUILDING
502 E. 9TH ST., DES MOINES, IA 50319-0034



OVERALL SITE PLAN

PAVEMENT PRESERVATION FOR:

UNION GROVE STATE PARK

TAMA COUNTY

NO.	BY	REVISION

DRAWN BY: TDD	PROJECT NUMBER: 22-05-86-01
CHK'D BY:	DATE: NOVEMBER 2022

SHEET No:

D.01

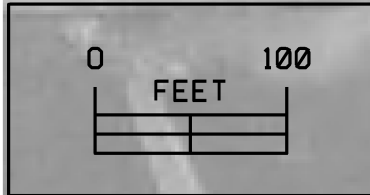
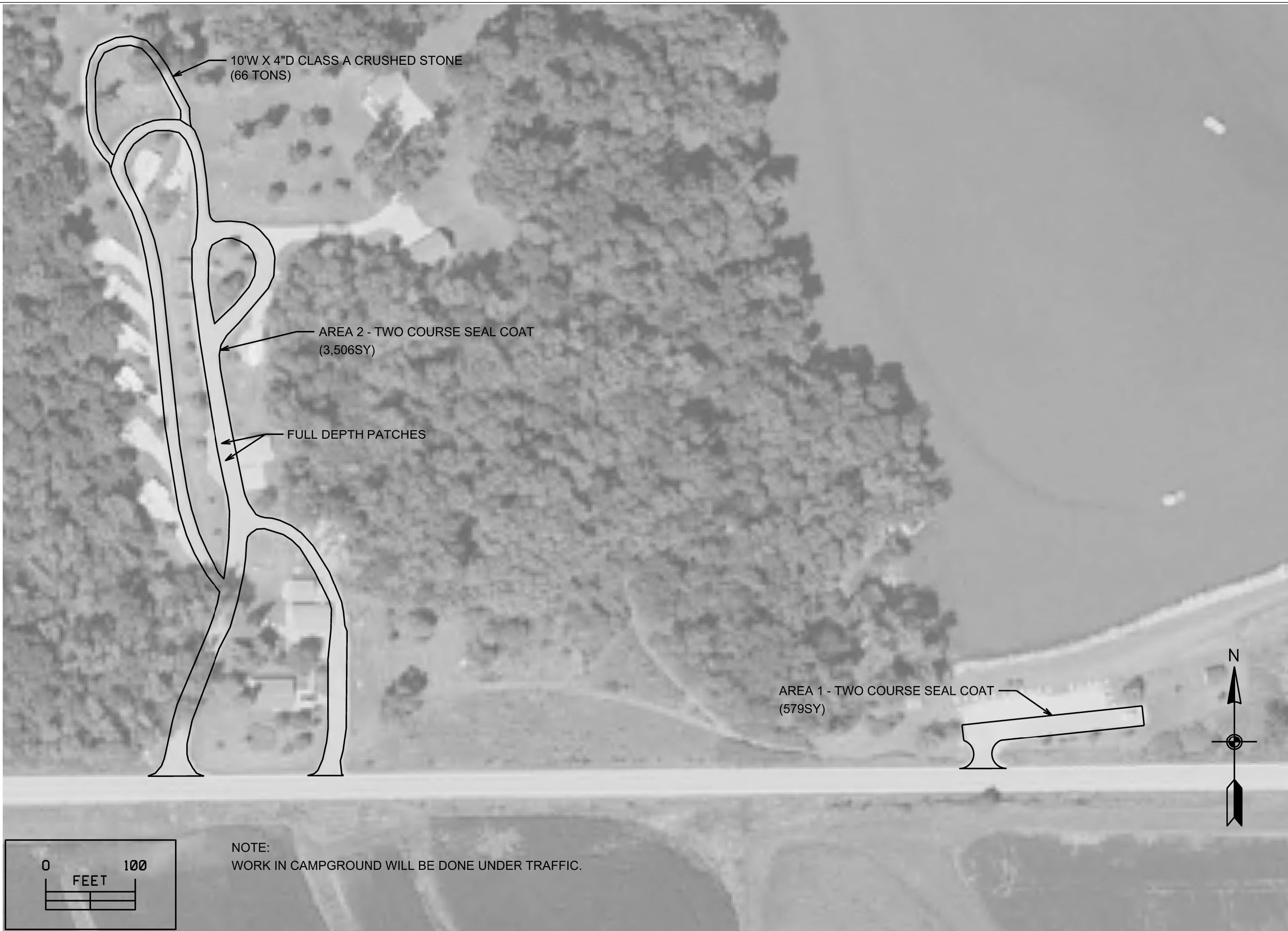

NOTE:
WORK IN CAMPGROUND WILL BE DONE UNDER TRAFFIC.



CONSULTANT:

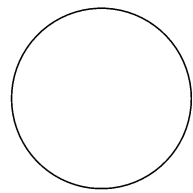

**IOWA DEPARTMENT OF
NATURAL RESOURCES**

ENGINEERING SERVICES - WALLACE BUILDING
502 E. 9TH ST., DES MOINES, IA 50319-0034



SITE PLAN - AREAS 1, 2

PAVEMENT PRESERVATION FOR:

UNION GROVE STATE PARK

TAMA COUNTY

NO.	BY	REVISION

DRAWN BY: TDD PROJECT NUMBER: 22-05-86-01

CHK'D BY: DATE: NOVEMBER 2022

SHEET No:

D.02



AREA 5 - 4" DEPTH CLASS A CRUSHED STONE
PLACE AS DIRECTED BY DNR FIELD ENGINEER
(21 TONS)

AREA 4 - 4" DEPTH CLASS A CRUSHED STONE
PLACE AS DIRECTED BY DNR FIELD ENGINEER
(14 TONS)

AREA 6 - 4" DEPTH CLASS A CRUSHED STONE
PLACE AS DIRECTED BY DNR FIELD ENGINEER
(22 TONS)

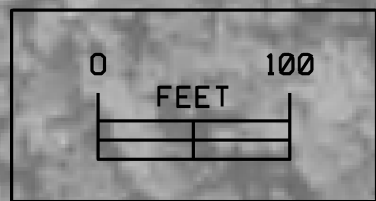

CONSULTANT:

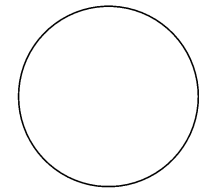

**IOWA DEPARTMENT OF
NATURAL RESOURCES**
ENGINEERING SERVICES - WALLACE BUILDING
502 E. 9TH ST., DES MOINES, IA 50319-0034



SITE PLAN - AREAS 4, 5, 6

PAVEMENT PRESERVATION FOR:
UNION GROVE STATE PARK
TAMA COUNTY

NO.	BY	REVISION
DATE		

DRAWN BY: TDD	PROJECT NUMBER: 22-05-86-01
CHK'D BY:	DATE: NOVEMBER 2022

SHEET No: **D.04**